

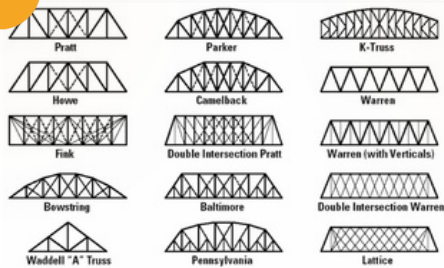

1



1. Select a truss bridge pattern
(see the Resources page)

2



2. Create 2 identical sides
using hot glue or tacky glue

3



3. Create a rectangular bottom
piece

4

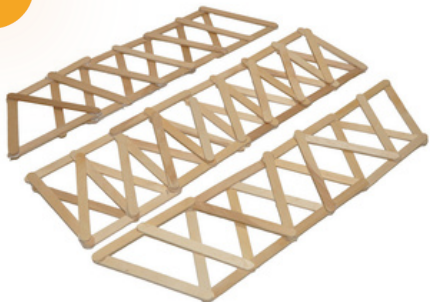

4. Arrange the pieces as shown

5



5. Combine the pieces with
cable ties

6



6. To test: place the bridge between 2 desks.
Weave the rope through the bridge in 2
places. Hang the scale, and pull until bridge
begins to show signs of breaking.